

Electric strikes from effeff



ATP Rim-type strike
MultiFix® A06

 **effeff**
ASSA ABLOY

Experience a safer
and more open world

MultiFix model range

14UA06, 24UA06, 34UA06, 142UA06



Strikes for special applications

„Surface mounting“

The new MultiFix rim-type strike combines design and functionality in one unique, patented unit.

The surface-mounted housing can be combined with existing effeff ATP door strikes renowned for their reliability.



Strike for special applications

Panic door lock with horizontal push bar

- Vertical and horizontal mounting possible
- For universal use – not handed
- Load and no-load version available
- Available with monitoring contact
- Available with locking function
- Three-dimensional adjustment (X: ± 3 mm / Y: 0-16 mm / Z: ± 3 mm) (see photo on right)
- Available with 12/24 V changeover switch and suppressor diode (e.g. for combination with access control system supplied by effeff)
- Housing colours: black, silver, white

MultiFix model range

Flexible in all dimensions

Adjustment options:

X: ± 3 mm
Y: 0 - 16 mm
Z: ± 3 mm

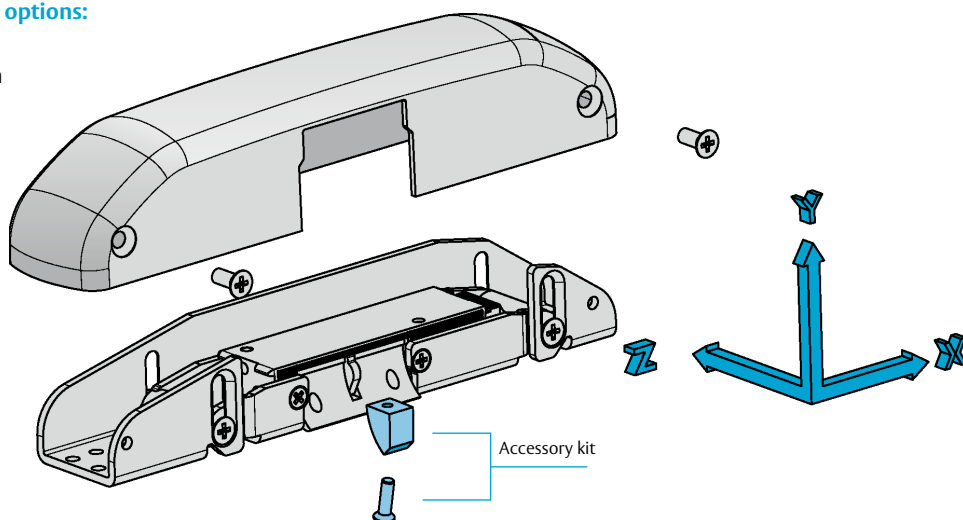

Accessories

By using the accessory kit the latch bolt function can be added. A snib prevents the latch from being retracted when the door is closed. The accessory kit is required to for the installation of suitable push bars.

Order no. accessory kit

SET-14U400080

Dimensions

The three-dimensional adjustability simplifies installation considerably and offers the option of subsequent adjustments thus covering all popular applications with minimal effort and without the necessity for alternative cover versions or spacers.

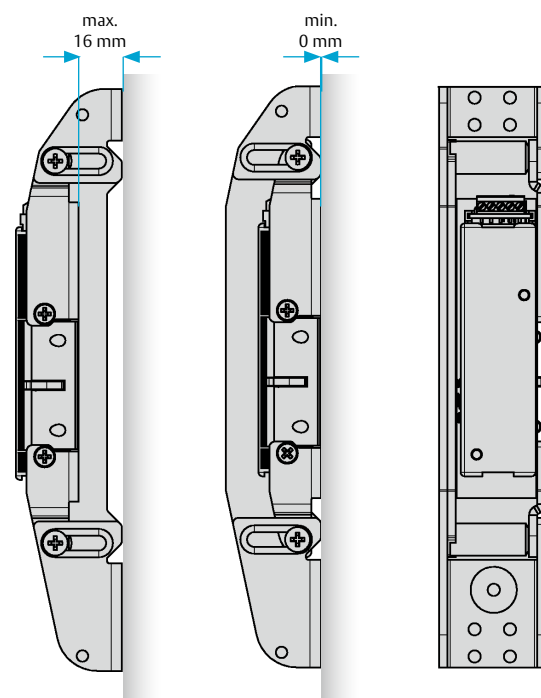
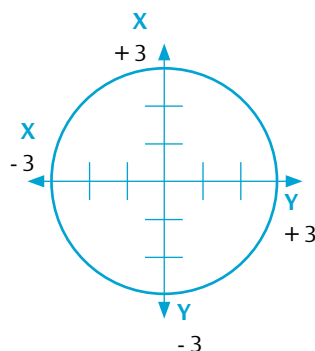

MultiFix model range

Technical data



Electrical data
at 20 °C

	Rated operating voltage Tolerance range	Nominal resistance in Ohm	AC consumption in mA	DC consumption in mA (50% residual ripple)	DC consumption in mA (stabilised)	Max. lock preload in N for AC	Max. lock preload in N for DC (50% residual ripple)	Max. lock preload in N for DC (stabilised)
12 V eE	± 1 V	57,5	130	190	210	50	20	10
24 V eE	± 2 V	230,0	70	100	105	50	20	10

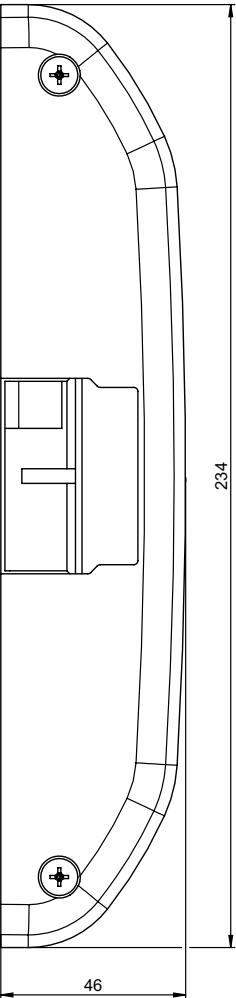
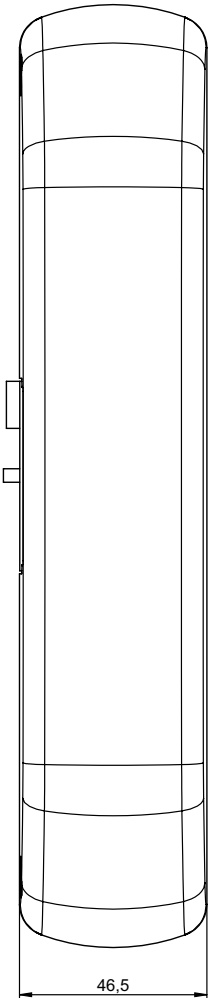

Technical data	
Intrusion resistance (standard)	5000 N
Break-in resistance 142U400/142U460	6500 N
Operating temperature range	-15 °C bis +40 °C
Mounting unrestricted by location	yes

Overview order no.
see page 5.

Model overview

All variants at a glance

Order numbers	12/24 V changeover switch	Suppressor diode	Monitoring contact	Locking function*	Fail-locked	Fail-unlocked	Black (RAL 9011)	Silver (RAL 9006)	White (RAL 9016)
1 4 U 4 0 0 - A 0 6 0 5 Q 3 1	•	•			•		•		
1 4 U 4 0 0 - A 0 6 9 1 Q 3 1	•	•			•			•	
1 4 U 4 0 0 - A 0 6 0 4 Q 3 1	•	•			•				•
1 4 U 4 6 0 - A 0 6 0 5 Q 3 1	•	•	•		•		•		
1 4 U 4 6 0 - A 0 6 9 1 Q 3 1	•	•	•		•			•	
1 4 U 4 6 0 - A 0 6 0 4 Q 3 1	•	•	•		•				•
2 4 U 4 0 0 - A 0 6 0 5 Q 3 1	•	•		•	•		•		
2 4 U 4 0 0 - A 0 6 9 1 Q 3 1	•	•		•	•			•	
2 4 U 4 0 0 - A 0 6 0 4 Q 3 1	•	•		•	•				•
3 4 U 4 0 0 - A 0 6 0 5 Q 3 1	•	•				•	•		
3 4 U 4 0 0 - A 0 6 9 1 Q 3 1	•	•				•		•	
3 4 U 4 0 0 - A 0 6 0 4 Q 3 1	•	•				•			•
3 4 U 4 6 0 - A 0 6 0 5 Q 3 1	•	•	•			•	•		
3 4 U 4 6 0 - A 0 6 9 1 Q 3 1	•	•	•			•		•	
3 4 U 4 6 0 - A 0 6 0 4 Q 3 1	•	•	•			•			•
1 4 2 U 4 0 0 A 0 6 0 5 Q 3 1	•	•			•		•		
1 4 2 U 4 0 0 A 0 6 9 1 Q 3 1	•	•			•			•	
1 4 2 U 4 0 0 A 0 6 0 4 Q 3 1	•	•			•				•
1 4 2 U 4 6 0 A 0 6 0 5 Q 3 1	•	•	•		•		•		
1 4 2 U 4 6 0 A 0 6 9 1 Q 3 1	•	•	•		•			•	
1 4 2 U 4 6 0 A 0 6 0 4 Q 3 1	•	•	•		•				•
Surface-mounted housing (complete), loose							•		
- - - - - A 0 6 0 5 - 0 1									
- - - - - A 0 6 9 1 - 0 1								•	
- - - - - A 0 6 0 4 - 0 1									•
Accessory kit									
S E T - 1 4 U 4 0 0 0 8 0									

 = Fire protection approval

* = Exchange controlled

The ASSA ABLOY Group is the global leader
in access solutions. Every day we help
people feel safe, secure and experience
a more open world.

ASSA ABLOY
Opening Solutions

ASSA ABLOY
Sicherheitstechnik GmbH
Bildstockstraße 20
72458 Albstadt
GERMANY
Tel. +49 7431 123-700
albstadt@assaabloy.com
www.assaabloyopeningsolutions.de